



21+ FORD BRONCO

REAR BUMPER SENSOR BRACKET

INSTALLATION INSTRUCTIONS

FSB01

Thanks for purchasing a Reaper Off-Road rear bumper sensor bracket for your 21+ Ford Bronco. Our team has worked to ensure that this product is the premium in performance, quality, and fitment. We are proud to say that this product will enhance the look and off-road performance of your vehicle. We encourage you to read through the following steps, and check the included Bill of Materials before beginning. Please follow these steps to ensure that your installation goes as planned.

Our products are specifically designed with ease of installation in mind. However, if you are uncomfortable with the following instructions please seek professional assistance. Reaper Off-Road will not be held liable for harm or injury to yourself or your vehicle during installation or use of this product.

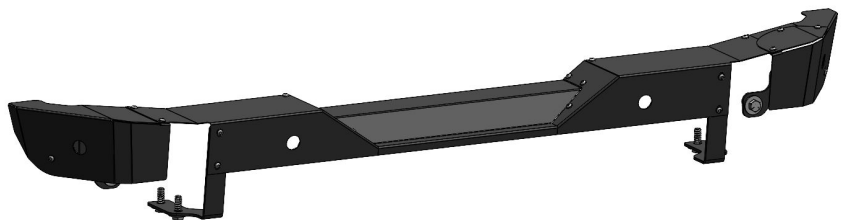

Recommended Tool List

- Metric socket set
- Inch socket set
- Ratchet
- Plastic rivet removal tool
- Hex key set
- Pocket knife

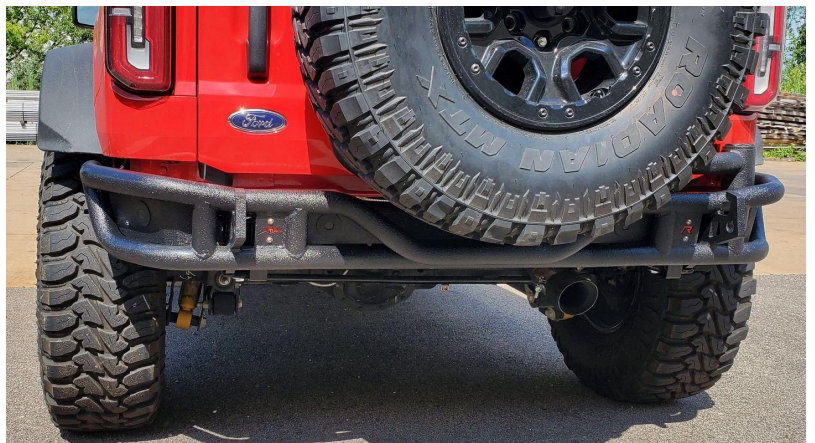



R1028
V01 - 8.31.22



Visit us online:
ReaperOffRoad.com

Call Us Toll-Free:
844-868-3022

 [reaper.off.road](https://www.instagram.com/reaper.off.road)
 [Reaper-Off-Road](https://www.facebook.com/Reaper-Off-Road)

DISASSEMBLY

Steps may vary depending on trim level and optional equipment.

- A1.** Disconnect the wiring harness from the plug below the driver side tail light. Vehicles with rear sensors will have a plug at the passenger side to disconnect as well.
- A2.** Use an 18mm socket to remove (4) bolts under the frame rail - (2) at each side. Remove tow hooks (if equipped).
- A3.** Use a 13mm socket to remove (2) bolts from the tabs at the outside of the frame - (1) per side. Remove the bumper from the vehicle.
- A4.** Begin removing the wire harness from the rear bumper. Use a trim removal tool to free each clip location.
- A5.** If sensors are equipped, take notice of the multi-piece design of the sensor housings. You will need to spread the black clips to free the sensor from the mount. Next you will need to squeeze that same portion to push it through the collar and through the bumper. The pieces should be marked (ex: ROL = rear outside left). You will need to keep these pieces matched to correctly for installation. Mark pieces as needed.
- A6.** Due to variation between trim levels, you will need to use a knife to carefully trim off the small alignment tabs around the flange on the sensor housings.



Detail A2: Remove OEM hardware



Detail A5: Sensor detail



Detail A6: Remove alignment tabs

R1028
V01 - 8.31.22

ASSEMBLY

Steps may vary depending on trim level and optional equipment.

For installs with other Reaper products, this kit must be installed after the tire carrier (FTC01) and before the rear bumper (FRB01).

- B1.** Begin by installing the inner right and left mounting brackets. Each one will jog towards the center when correctly installed. If you have a Reaper tire carrier (FTC01), the passenger side bracket will install below the carrier mounting bracket. Secure each bracket with (2) M12 bolts(C) and (2) washers(F). Be sure to use the correct hardware - these will be the bolts marked "8.8" on the head. Do not fully tighten the bolts yet.
- B2.** Off the vehicle, assemble the mid left plate and the mid right plate to the center plate. Use (8) 1/4" screws(A) and (8) washers(E) to secure the pieces. Each screw should align near the center of the slot and the bottom edges will align. Start all hardware before fully tightening with a 5/32" hex key.
- B3.** Install the assembled center section onto the inner mounting brackets using (4) 1/4" screws(A) and (4) washers(E). Align the screws at the upper end of the slots. If you are installing this product with a Reaper tire carrier, the passenger side will align at the bottom end of the slots.
- B4.** Check that the installed pieces are centered correctly. Tighten the M12 hardware below the frame using a 19mm socket.
- B5.** Install the left outer corner. Align the screws at the center of the slots. Secure with (2) 1/4" screws(A) and (2) washers(E).
- B6.** Install the right outer corner. For installs without a Reaper tire carrier, you will also install the right corner cover. If you have the tire carrier installed, this cover will not be used. Use (2) or (4) screws(A) and washers(E) to secure.



Detail B1: Install inner brackets



Detail B2: Assemble center sections



Detail B5: Install left outer section

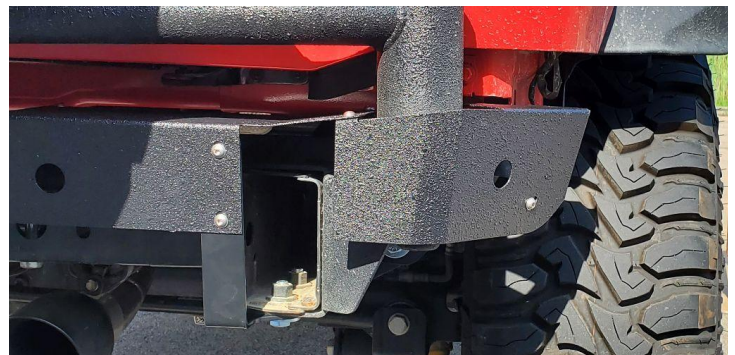

Detail B6: Right outer section installed (with FTC01)

R1028
V01 - 8.31.22

ASSEMBLY (continued)

- B7.** Install the outer mount brackets. These will align to the outer ends of the frame, at the slot under the body mount. Be sure to use the correct bracket at each side - the short leg will point toward the front of the vehicle and will align to the hole at the outer corner section. Secure each with (1) 1/2" bolt(B), (2) 1/2" washers(F), (1) 1/2" nut(D), (1) 1/4" screw(A), and (1) 1/4" washer(E). The right side is again designed with adjustment based on whether you have a tire carrier. The 1/4" screw will align at the bottom of the slot if a tire carrier is installed, otherwise it will align at the top of the slot.
- B8.** Trim plugs are included for vehicles without OEM sensors. If you will be using these, press (4) plugs(H) into the sensor holes, installing from the outside face. Use the large spacer(G) at the inside to secure fully.
- B9.** For vehicles with sensors, reinstall the sensor housings at the correct locations. Install the flanged portion through the outside face. Assemble the large spacer(G) followed by the white piece of the housing to secure. The pieces should click together without force - check alignment of tabs and adjust as needed.
- B10.** Reinstall the wire harness for the sensors. If your harness has a plug at each end, it will be directional with a different plug at each end. Make sure to run the ends of the harness over the frame rail.
- B11.** The sensor harness may need to be modified to fit the new width of the inner two sensors. For the inner two sensors, carefully cut and peel the tape about 1" towards the outer end of where the wiring branches out. Open the plastic wire loom and carefully cut the extra band of tape to allow the wiring to stretch further. Retape as needed.
- B12.** Reinstall sensors at proper locations and connect the harness at each location. Use zip ties to secure any loose wiring.
- B13.** Installation is complete. Continue on to the rear bumper install instructions.

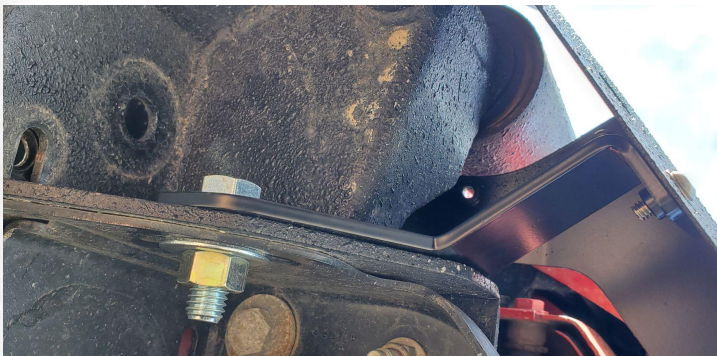

Detail B7: Outer right bracket installed (with FTC01)

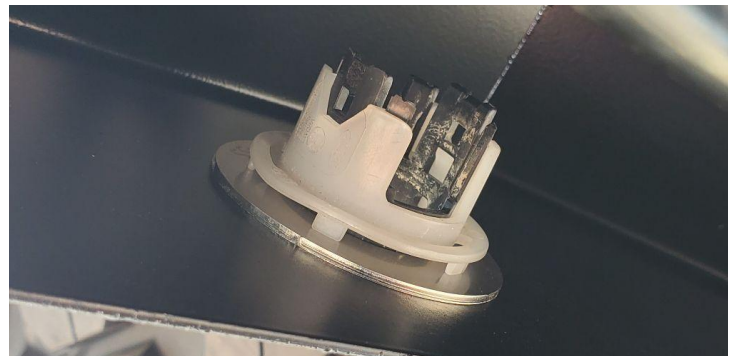

Detail B9: Assemble sensor housings

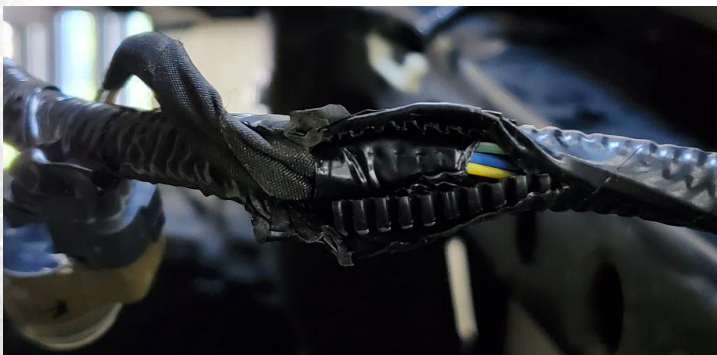

Detail B11: Open wire loom to extend wire reach

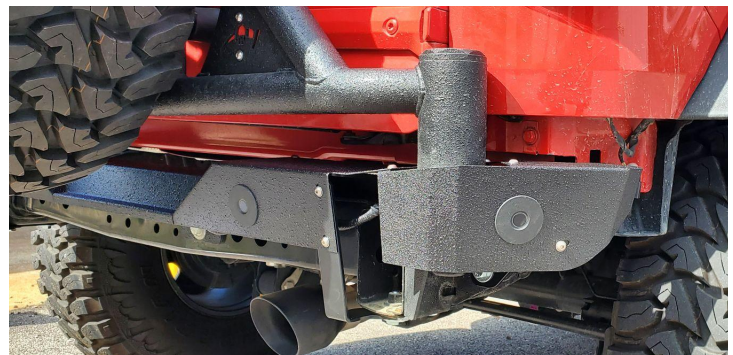

Detail B13: Installation complete

R1028
V01 - 8.31.22