



07-18 JEEP WRANGLER JK/JKU

FRONT SKID PLATE INSTALLATION INSTRUCTIONS

JSK01

Thanks for purchasing a Reaper Off-Road front skid plate for your Wrangler JK. Our team has worked to ensure that this product is the premium in performance, quality, and fitment. We are proud to say that this product will enhance the look and off-road performance of your vehicle. We encourage you to read through the following steps, and check the included Bill of Materials before beginning. Please follow these steps to ensure that your installation goes as planned.

Our products are specifically designed with ease of installation in mind. However, if you are uncomfortable with the following instructions please seek professional assistance. Reaper Off-Road will not be held liable for harm or injury to yourself or your vehicle during installation or use of this product.

Recommended Tool List

- Plastic rivet removal tool
- Metric socket set
- Inch socket set
- Ratchet
- Reciprocating Saw





R1017
V01 - 7.13.21



Visit us online:
ReaperOffRoad.com

Call Us Toll-Free:
844-868-3022

 [reaper.off.road](https://www.instagram.com/reaper.off.road)
 [Reaper-Off-Road](https://www.facebook.com/Reaper-Off-Road)

DISASSEMBLY

07-18 JEEP WRANGLER JK/JKU

FRONT SKID PLATE

PAGE 2

Steps may vary depending on trim level and optional equipment. These instructions are written based upon installation with OEM equipment. This skid plate can be installed either before or after a Reaper front bumper, but we recommend installing the bumper first.

1. Locate the (4) push clips around the front lip of the OEM plastic skid plate. Use a trim removal tool or a screwdriver to wedge between the head and the flange. Pop the head up to loosen, then remove each clip.
2. Remove the (2) additional clips at the back tabs of the skid plate, where it connects to the crash bar.
3. Remove the OEM skid plate from the vehicle.
4. Early models (2007-2011) will have a frame that looks like the one in detail 4. If the horizontal U-shaped piece (crash bar) extends past the vertical piece, it will need to be trimmed back for fitment. Mark a line on the crash bar, in-line with the outside vertical face. Use a sawzall to remove the excess material. We recommend deburring any rough edges and applying spray paint to the bare metal.



Detail 1a: Remove plastic clips around front lip



Detail 1b: Loosened push clip



Detail 2: Remove push clips at back tabs



Detail 4: Early model frame (crash bar)

R1017
V01 - 7.13.21

ASSEMBLY

07-18 JEEP WRANGLER JK/JKU

FRONT SKID PLATE

PAGE 3

This skid plate includes an accent plate that can be customized to the color of your choice or left as is. If you would like to paint or powder coat the plate, do so before continuing.

5. Install the logo backing plate to the inside of the skid plate. Use the ¼" nuts (C) and a 7/16" socket to secure.
6. Locate the L-shaped mid mounting brackets. One will be marked with a "D" for the driver side and the other will have a "P" for the passenger side. The arrow designates the "up" direction.
7. Install each mid mounting bracket into the crash bar on the designated side. You will need to position the bracket so that the "up" leg is inside the vertical section of the frame. Align the holes on each mounting bracket to the holes on the sides and back of the frame rails.
8. Have a friend help to position the skid plate, while you install (2) M10 bolts (A), and washers (B) through the back holes and into the nuts on the mounting brackets. Do not fully tighten yet.
9. Install (2) more M10 bolts (A) and washers (B) into the holes on the vertical section and into the nuts on the mounting brackets.
10. Use a 17mm socket to secure all (4) bolts.

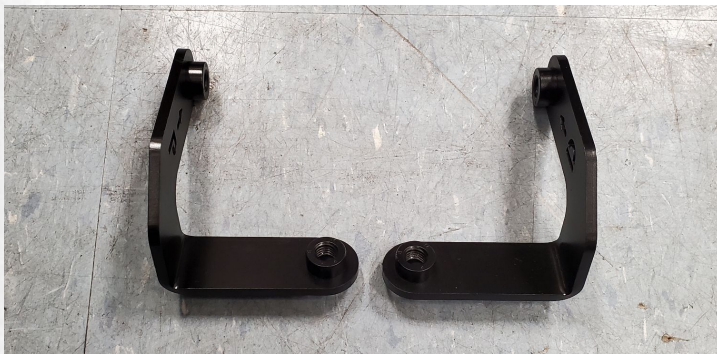

Detail 6: Mid mounting brackets

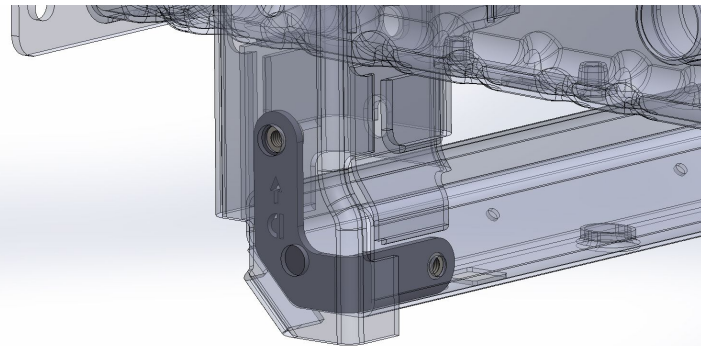

Detail 7: Driver side mounting bracket installed



Detail 8: Install bolts through rear holes



Detail 9: Install bolts through side holes

R1017
V01 - 7.13.21